

BESC2014 2014 International Conference on Behavioral, Economic and Socio-Cultural Computing

30 October - 1 November, 2014, Shanghai, China

<http://datamining.it.uts.edu.au/conferences/besc14/>

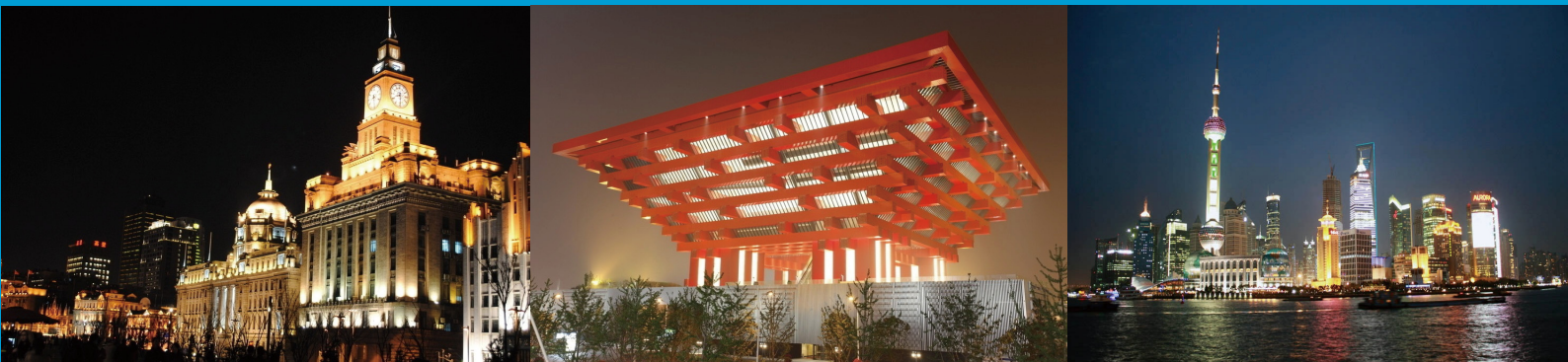

Behavioral, economic and socio-cultural aspects are increasingly recognized as key components in business intelligence and problem-solving. Accordingly, Behavioral, Economic and Socio-cultural Computing (BESC) has been emerged as new scientific fields that study effective methodologies, techniques and tools for

- deeply understanding cognitive and psychological capacities of human beings, and cultural, economic, social, political, legal, online, social media, spatial, environmental, and biological factors, systems, organizations, and institutions;
- effectively representing, modeling, analyzing, simulating, evaluating and managing behavioral, economic, social and cultural phenomena, factors, characteristics, dynamics, evolution, consequence and knowledge;
- developing quantitative and computational methodologies, approaches, algorithms, tools and systems towards a deeper understanding of dynamics and evolution, relations and interactions, structures and distributions, rules, patterns and exceptions, effects and consequences, and intelligence and emergence in individual and collective BESC entities, systems and organizations;

- delivering a deep modeling, analysis and learning of social concepts including trust, credibility, privacy and influence, and intrinsic behavior/economic/socio-cultural patterns and impacts; and
- showcasing the intellectual, value, process, and impact contexts that govern the development and use of science and technology into various BESC applications and domains.

BESC2014 aims to increase potential collaborations and partnerships by bringing together academic researchers and industry practitioners from data mining, statistics and analytics, business and marketing, finance and politics, and behavioral, economic, social and psychological sciences with the objectives to present updated research efforts and progresses on foundational and emerging interdisciplinary topics of BESC, exchange new ideas and identify future research directions.

Important Dates

- Paper Submission deadline: 12 July, 2014
- Notification of acceptance: 10 August, 2014
- Final Camera-ready papers due: 30 August, 2014

Submission Guidelines

Paper submissions should be limited to a maximum of seven (7) pages, in the IEEE 2-column format. All submissions will be blind reviewed by the Program Committee on the basis of technical quality, relevance to conference topics of interest, originality, significance, and clarity. Author names and affiliations must not appear in the submissions, and bibliographic references must be adjusted to preserve author anonymity.

Advisory Committee

- Usama Fayyad, Barclays Bank, UK
- Masaru Kitsuregawa, University of Tokyo, Japan
- Rao Kotagiri, University of Melbourne, Australia
- Vipin Kumar, University of Minnesota, USA
- Bengchin Ooi, National University of Singapore
- Xin Yao, University of Birmingham, UK
- Philip S Yu, University of Illinois at Chicago, USA

Steering Committee

- Longbing Cao, University of Technology, Sydney, Australia
- Shu-Heng Chen, National Chengchi University, Taiwan
- Geun-Sik Jo, Inha University, South Korea
- Irwin King, Chinese University of HongKong, China
- Ee-Peng Lim, Singapore Management University
- Huan Liu, Arizona State University, USA
- Wolfgang Nejdl, Leibniz Universitat Hannover, Germany
- Yong Shi, Chinese Academy of Sciences, China
- V.S. Subrahmanian, University of Maryland, USA
- Feiyue Wang, Chinese Academy of Sciences, China
- Guandong Xu, University of Technology, Sydney Australia

General Chairs

- V.S. Subrahmanian, University of Maryland, USA
- Shu-Heng Chen, National Chengchi University, Taiwan

Conference Chairs

- Osmar Zaiane, University of Alberta, Canada
- Herve Martin, Laboratoire d'Informatique de Grenoble, France

- Geun-Sik Jo, Inha University, South Korea
- Jian Cao, Shanghai Jiaotong University, China

Program Committee Chairs

- Huan Liu, Arizona State University, USA
- Guandong Xu, University of Technology, Sydney, Australia
- Wolfgang Nejdl, Leibniz Universitat Hannover, Germany

Local Arrangement Chairs

- Hongming Cai, Shanghai Jiaotong University, China
- Wei Liu, University of Technology, Sydney, Australia

Workshop Chairs

- Bo An, Nanyang Technological University, Singapore
- Ya Zhang, Shanghai Jiaotong University, China
- Jie Wang, Stanford University, USA

Tutorial Chairs

- Jiuyong Li, South Australia University, Australia
- Jaideep Srivastava, University of Minnesota, USA

Panel Chairs

- Gabriella Pasi, Universitadi Milano Bicocca, Italy
- Ee-Peng Lim, Singapore Management University, Singapore

Sponsorship Chairs

- Guangtao Xue, Shanghai Jiaotong University, China

Publicity Chairs

- Xiaohui Tao, University of Southern Queensland, Australia
- Xin Wang, University of Calgary, Canada
- Xiaodong Yue, Shanghai University

Registration/Finance Chair

- Qi Gu, Shanghai Jiaotong University, China

Publication Chair

- Frank Jiang, University of Technology, Sydney, Australia

Scope and Topics

- Computational foundations: including statistical/mathematical/logic/evolutionary/formal methodologies, models and theories for engineering, representing, visualizing, analyzing, modeling, evaluating and managing cognitive, behavioral, economic, political, online, social media-based, and socio-cultural phenomena, factors, interactions, relations, structures, contexts and situations, systems and organizations; and for understanding their formation and evolution, dynamics, self-organization, mobility, learning and adaptation, change and emergence, influence, conventions, trust, norms, protocols, roles, responsibilities, utility, effects, privacy, risk, security, and decision-making and formation processes;
- Techniques and approaches: including specific tools, algorithms, models, systems, evaluation metrics for acquisition, extraction, detection, summarization, knowledge representation, visualization, classification, regression, clustering, pattern discovery, factor/event/effect analysis, reasoning, relation/structure/distribution analysis, collaborations/conflicts/negotiation mechanisms and crowding/community formation/grouping and diffusion understanding of BESC related systems and organizations; and for collecting, analyzing, managing and utilizing BESC-related networking, textual, imaging, sequential, spatio-temporal, multimedia, graphic and streaming data; and
- Applications and systems: including innovative use and showcases, simulation and visualization of BESC problems not limited to networking, socialization, globalization, exception

and risk management, crisis analysis and management, security, compliance, recommendation, retrieval and search, innovation, and decision-support.

Publications

All accepted papers will be published by IEEE and IEEE Xplore. The conference proceedings will be submitted for EI indexing through INSPEC by IEEE. Selected top quality papers accepted and presented in the conference for extension and publication in the special issue of some international journals, including IEEE Intelligent Systems, WWWJ, and Neurocomputing. The accepted workshop papers will be published through Springer CCIS series.

Technical Sponsors

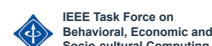

Conference organizers

